

HOW TO FIT...

# PLASTIC RIM / MORTICE KNOBSET



1.

Locate the rose of the knob set onto each side of the door and fix into place over the latch follower holes (this will only need to be done on one side if a rim lock is being used).

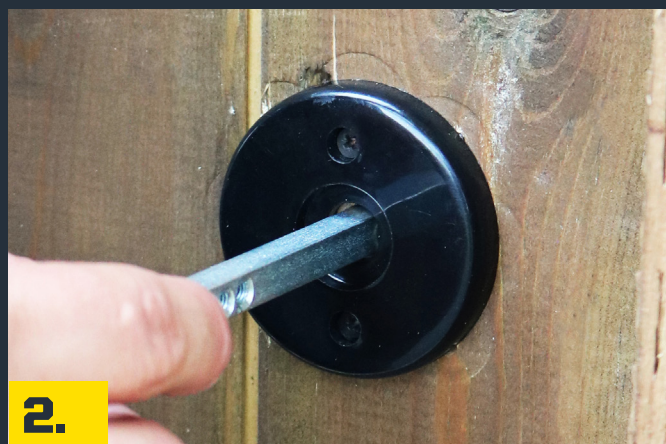

2.

Pass the spindle through the latch follower in the lock.



3.

Locate the knobs onto the spindle on each side of the door and tighten the grub screws to the spindle to hold in place.

